



Worton Drive

Darlington DL1 4JY

£120,000





This footer paragraph is an example only and should not be relied upon as complying with current legislation. These particulars, whilst believed to be accurate are set out as a general outline only for guidance and do not constitute any part of an offer or contract. Intending purchasers should not rely on them as statements of representation of fact, but must satisfy themselves by inspection or otherwise as to their accuracy. No person in this firms employment has the authority to make or give any representation or warranty in respect of the property.



This footer paragraph is an example only and should not be relied upon as complying with current legislation. These particulars, whilst believed to be accurate are set out as a general outline only for guidance and do not constitute any part of an offer or contract. Intending purchasers should not rely on them as statements of representation of fact, but must satisfy themselves by inspection or otherwise as to their accuracy. No person in this firms employment has the authority to make or give any representation or warranty in respect of the property.

Worton Drive

Darlington DL1 4JY



- Two Bedroom Semi Detached Property
- Well Positioned For Travel & Transport Links
- EPC Rating tbc

- Eastbourne Area of Darlington
- Priced to Sell

- Gardens To Front & Rear
- Council Tax Band A

In the Eastbourne area of Darlington, this two bedroom semi-detached house offers a perfect blend of comfort and convenience. With two well-proportioned bedrooms, this property is ideal for small families, couples, or individuals seeking a peaceful retreat.

Upon entering, you are welcomed into a spacious reception room that provides a warm and inviting atmosphere, perfect for relaxation or entertaining guests. The layout flows seamlessly, allowing for easy movement throughout the home. The property boasts a well-appointed bathroom, ensuring all your essential needs are met.

One of the best features of this residence is the off-street parking, providing a secure space for vehicles, which is a valuable asset in this area. Additionally, the house is complemented by gardens to both the front and rear, offering a delightful outdoor space for gardening enthusiasts or those who simply wish to enjoy the fresh air.

Located in the desirable Eastbourne area of Darlington, this property benefits from a friendly community and is conveniently situated near local amenities, schools, and transport links. Whether you are looking to settle down or invest, this charming two-bedroom home on Worton Drive presents an excellent opportunity. Do not miss the chance to make this lovely house your new home.

Entrance Hall

Door to side, staircase to first floor with under stairs storage cupboard, housing combi boiler.

Lounge

12'4 x 9'3 (3.76m x 2.82m)

Upvc double glazed bow window to front and wood flooring and radiator.

Kitchen

11'2 x 11'00 (3.40m x 3.35m)

Upvc double glazed window and door to rear, fitted with wall, base and drawer units, stainless steel sink with mixer tap, integrated electric hob with extractor over and oven. Space for a washing machine, dishwasher and dining table. Radiator and access to under stairs storage cupboard.

First Floor Landing

Bedroom One

16'8 x 10'11 (5.08m x 3.33m)

Upvc double glazed window to front.

Bedroom Two

11'2 x 9'11 (3.40m x 3.02m)

Upvc double glazed window to rear.

Bathroom

Upvc double glazed window to side, bath with mixer taps, low level w.c and wash hand basin.

Externally

To the front there is a driveway and low maintenance lawn area with access to the rear garden.

To the rear is mainly laid to lawn with concrete patio area.

Tenure

Freehold

Property Details

Local Authority: Darlington

Council Tax Band: A

Annual Price: £1,581

Conservation Area No

Flood Risk Very low

Floor Area 0 ft 2 / 0 m 2

Plot size 0.05 acres

Mobile coverage

EE

Vodafone

Three

O2

Broadband

Basic

2 Mbps

Superfast

45 Mbps

Ultrafast

10000 Mbps

Satellite / Fibre TV Availability

BT

Sky

Virgin

Note

IMPORTANT NOTE TO PURCHASERS: We endeavour to make our sales particulars accurate and reliable, however, they do not constitute or form part of an offer or any contract and none is to be relied upon as statements of representation or fact. The services, systems and appliances listed in this specification have not been tested by us and no guarantee as to their operating ability or efficiency is given. All measurements have been taken as a guide to prospective buyers only, and are not precise. Floor plans where included are not to scale and accuracy is not guaranteed. If you require clarification or further information on any points, please contact us, especially if you are travelling some distance to view. Fixtures and fittings other than those mentioned are to be agreed with the seller. We cannot also confirm at this stage of marketing the tenure of this house.

Disclaimer

**Photographs are not current and up to date, only for guide purposes.

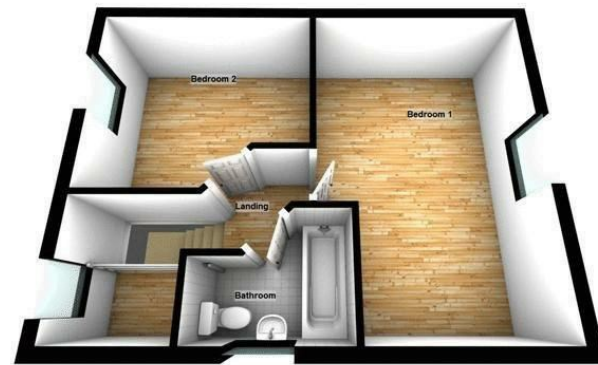
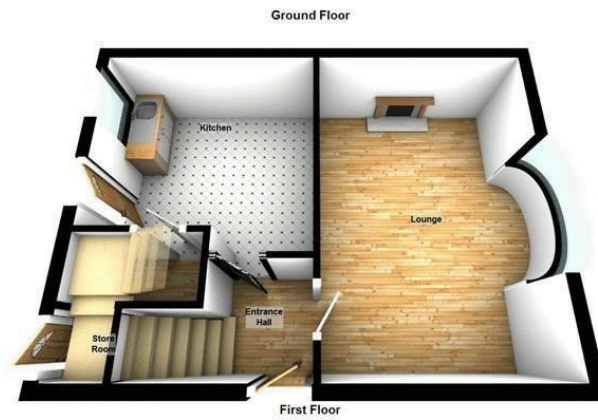

Floor Plan(s) Not To Scale For illustrative purposes only
Plan produced using The Mobile Agent

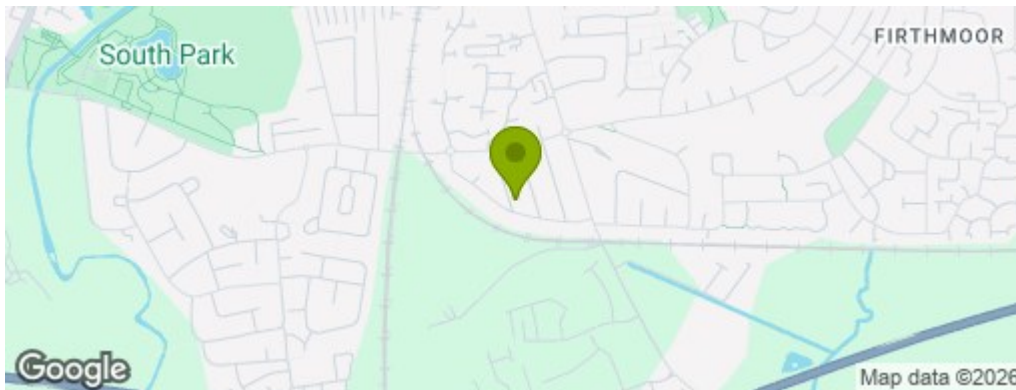

Property Information

01325 363858

45 Duke Street, Darlington, County Durham, DL3 7SD
sales@venturepropertiesuk.com